

Enjoy luxury holiday
home ownership at
**Culzean Bay and
Croyburnfoot**



The Lochwood

Holiday Homes with
stunning views across
the Firth of Clyde, Isle of
Arran and Ailsa Craig.

Creating your Victory



Innovation is in our DNA

Our team of innovation experts have turned traditional manufacturing processes on their head. From tweaks to interior configuration to working with our suppliers to develop materials that are more sustainable and future-proof - we never stand still in our commitment to give you the best holiday homes on the market.



Quality craftsmanship

Quality is at the heart of everything we do. Our unrivaled craftsmanship is renowned across the country and our long-standing customers, with whom we've developed strong relationships, are a testament to this.

You come first

Despite being one of the newest leisure home manufacturers in the UK, we're fast becoming the supplier of choice because of our reputation for customer service excellence. We aim to get it right first time. But on the rare occasion we might not, we make sure to put it right with no fuss. That's the Victory way.

Two year warranty

The combination of solid construction and contemporary design, integrated with comfort and function, demonstrates the depth of knowledge and experience of the entire Victory team. This underpinning gives us the confidence to offer a two-year warranty to all purchasers within the UK subject to certain terms and conditions. For purchasers outside of the UK, please refer to your supplier for warranty details. The warranty available is additional to and does not affect your statutory rights under consumer legislation.



Included as standard with your Victory:

- Novus wall system for a truly domestic look and feel throughout
- Novus composite floor to reduce bounce and save energy
- Top range models include our industry-leading lightweight, high-strength, fully galvanised chassis
- Sustainably-sourced materials to reduce the carbon footprint of all our products
- 100mm insulated roof
- 45mm wall insulation
- High compressive strength floor insulation
- Domestic gutters and downpipes
- Domestic interior doors and window frames
- Front and rear anthracite fascia and roof cappings
- Thermostatic shower mixer valve
- Low energy bulbs throughout and LED bulbs in all spotlights
- Steel pantile roof
- 10-year smoke detector and 2 carbon monoxide detectors
- Fire extinguisher and escape windows
- Exterior light near entrance

All features correct at time of print August 2023. Features and options subject to change.

Accreditations

We're recognised by the best and partner with the best.



THE Lochwood

If you're looking for sumptuous living with clever, space-saving design, the Lochwood has everything you need. Designed for families who are looking for a contemporary yet functional space, perfect for hosting and relaxing. The Lochwood boasts a comfy L-shaped sofa - which is perfect for movie nights - as well as a master suite with an en-suite.

Experience the charm of the Lochwood – a perfect blend of functional features and cosy, contemporary interior design.

Key features:

- A modern galley kitchen
- Comfy L-shaped sofa
- Refreshed soft furnishings and lighting
- Available in 2 and 3 bed options
- Plenty of storage throughout

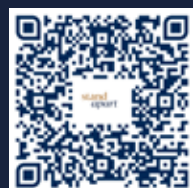

Scan to view full specification,
or visit victoryleisurehomes.co.uk





Sumptuous open
plan *Living*



Lochwood

FLOOR PLANS

Scan to view full specification,
or visit [victoryleisurehomes.co.uk](https://www.victoryleisurehomes.co.uk)

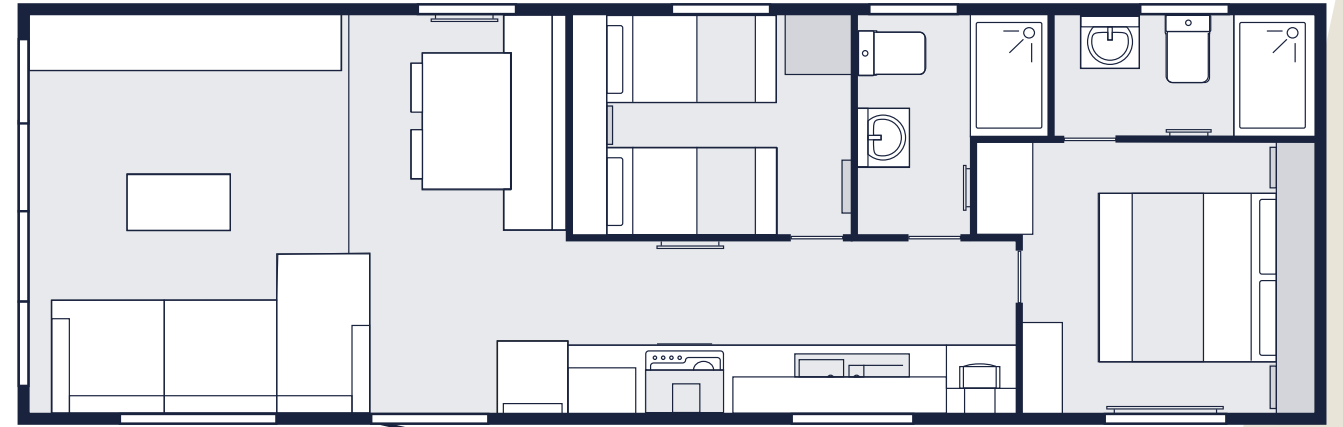

1. 38 ft x 12 ft 2 Bedrooms



2. 41 ft x 12 ft 3 Bedrooms



CULZEAN BAY
HOLIDAY HOMES

Knoweside, Croy Shore,
South Ayrshire, KA19 8JS
culzeanbay.com

CROYBURNFOOT
HOLIDAY HOMES

Croy Shore, Maybole
South Ayrshire, KA19 8JS
croyburnfoot.com

If you have any questions, call or email us on

Tel **01292 500 444**, email sales@culzeanbay.com or pop into the sales office.